

Security Services

Security issues are mission critical for the transit industry. With a host of federal and best practice documents creating a response framework, transit managers need to be diligent in their approach. Gannett Fleming performs all levels of transit security planning, design, and construction management. Our team possesses in-depth knowledge of security issues that are on the minds of transit and rail operators.

Our firm can assist you in assessing and mitigating transit infrastructure vulnerabilities and help you understand your susceptibilities and risks. With this knowledge, you can position yourself to be better prepared with critical security plans that are customized and prioritized for your organization.

Security technology is constantly evolving. Gannett Fleming stays abreast of new products before they are implemented in the marketplace and uses this knowledge to provide strategic consulting services relating to all aspects of transit security, including:

- Threat, vulnerability, and risk analysis for physical assets
- Design of physical protection system strategies including:
 - blast analysis and hardening
 - fencing and barriers
 - intrusion detection, surveillance (CCTV), and access control systems
 - entry control strategies
 - public address and life safety systems
- Telecommunications systems design
- Development and integration of security plans, programs, policies, and procedures

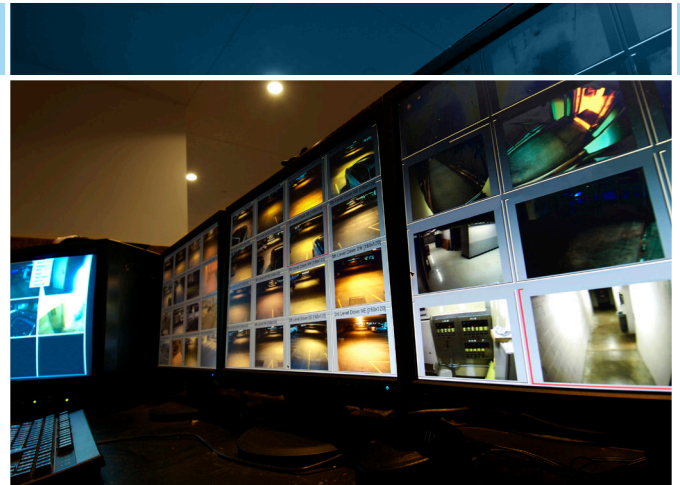

- Integration of crime prevention through environmental design (CPTED) methods into existing and new start projects
- Crisis and emergency response planning.

These tools can be used and integrated with your existing processes and operations to create sustainable, event-driven security systems.

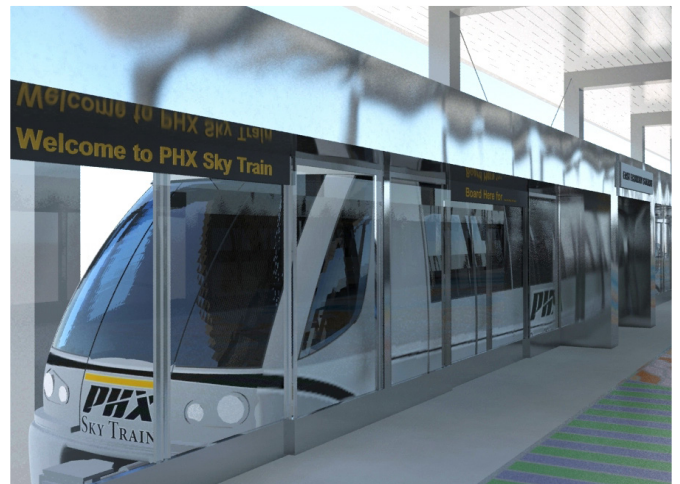

Transit & Rail Security Capabilities:

- Provided design-build services for Amtrak's electronic security systems at Union Station in Washington, D.C., including the integration of four legacy camera systems, security lighting, heating, ventilation, and air-conditioning (HVAC) units for the communications room, standby power diesel generator, and fiber-optic cable network.
- Provided security design services and blast analysis for the development of an automated train at the PHX Sky Harbor International Airport. Work included coordinating stakeholder interests, developing the design criteria document, performing vulnerability and security analyses of stations, terminals, and guideways, construction design plans, and developing related security strategies.
- Designed improvements to Southeastern Pennsylvania Transportation Authority's City Hall Station in Philadelphia, Pa., including removal of portions of supporting walls to improve station visibility and openness to provide passengers with a greater sense of security (CPTED).
- Provided oversight of an evacuation plan for a 1.4-mile downtown transit/bus tunnel for Central Puget Sound Regional Transportation Authority and the Federal Transit Administration.
- Designed an improved security system including infrared and thermal imaging cameras, video analytics systems, and network and physical infrastructure for the Wilmington Operations Center and Traffic Control facility.
- Designed improved security system for the Penn Coach Maintenance Yard, including infrared camera systems with video analytics, wireless nodes, and addition of aerial cable and fiber.
- Developed the design and engineering of electronic security systems (ESS) that included access control and alarm, fire detection and alarm systems, public address systems, lighting protection, and emergency generator systems for Metropolitan Atlanta Rapid Transit Authority (MARTA).
- Performed a threat and vulnerability assessment for the William Lehman Operations and Maintenance Center's 82-acre Miami-Dade Transit heavy rail maintenance facility, providing mitigation recommendations.
- Provided security design planning for a tri-venture, multi-disciplined bridge replacement over the Hackensac River including blast analysis, access control, and electronic and physical protection systems.
- Designed CCTV and vehicle barrier improvement for multi-use rail stations for AMTRAK in Philadelphia, Pa., Washington, D.C., and New Haven, Conn., including use of advanced 180 degree and 360 degree high-definition camera technology to provide 100 percent CCTV coverage of AMTRAK property.
- Designed and implemented a state-of-the-art physical security information management (PSIM) system for SAMTRANS/CALTRAIN, serving 20 Silicon Valley cities. Integrated access control, CCTV, and intrusion detection system, and provided procedures and workflows to automate security systems in response to adverse events.

www.gannettfleming.com

ISO 9001:2008
CERTIFIED

William Foos, CPP, PSP
wfoos@gfnet.com

McEwan van der Mandele, CPP
mvandermandele@gfnet.com

Offices Worldwide



BAMM00597-1115